



DNA Matkamokkula 5G WiFi U30 Modem

Setup instructions



Contents

Watch a short video to make it easier to set up the device.....	4
Contents of the package	6
Functions of the device.....	7
Setting up the Matkamokkula modem:	
1. Installing a SIM card	8
2. Turning on the Matkamokkula modem.....	10
3. Connecting devices wirelessly (WiFi)	12
Connecting devices with a USB-C cable	13
Changing the name and password of the WiFi network.....	14
Indicator lights explained.....	16

Watch a short **video** to make it easier to set up the device

Video



Scan the code and go to the support page to watch the video tutorial on how to set up your device.

For video tutorials, guidance on how to manage your device settings and updated setup instructions based on user feedback, visit dna.fi/tuki-mokkulat or scan the QR code on the following page using your phone's QR code scanner (camera).

Contents of the package

- Matkamokkula 5G WiFi U30 modem
- USB-C cable

The battery is packed separately in a cardboard sleeve at the bottom of the product package.

Additionally, there are 3 WiFi network QR code stickers included. The sticker contains the network name and password.

AC charger not included.

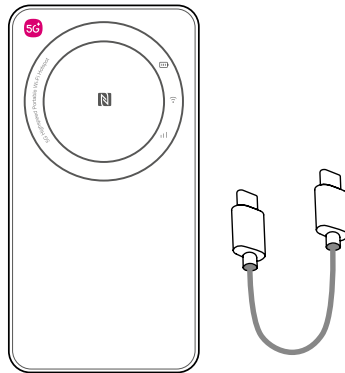

Functions of the device

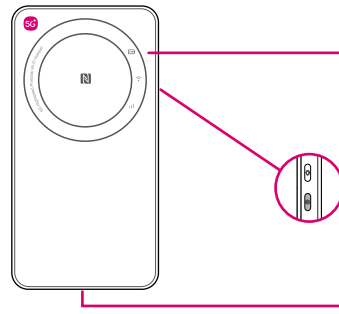

Indicator lights:

- Battery
- WiFi
- Mobile network

WiFi network selection button

Power button

Charging port

1. Installing a SIM card



The card includes three SIM cards of different sizes. Select the smallest SIM card, the Nano SIM card, and pop it out of the card.

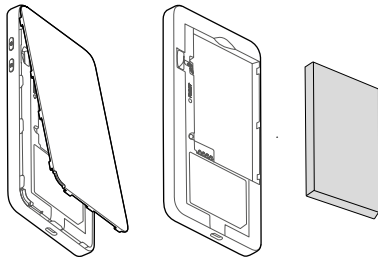

Remove the back cover. The SIM card is installed under the battery.

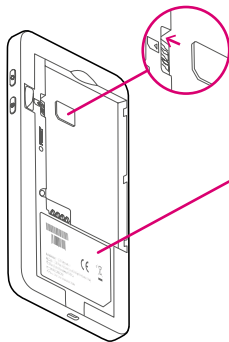

Insert the SIM card into the slot with the chip side down and the bevelled corner first.

The SIM card can be inserted all the way to the bottom, but it will not click into place.

Put the battery in and the back cover back on the device.

You will need this information to connect to the modem's WiFi network.

The information can also be found on the QR code stickers included in the package.

If the mobile network indicator light is solid red after turning on the device, the SIM card may not be inserted correctly.

2. Turning on the Matkamokkula modem

Press and hold the power button for three seconds to turn on the Matkamokkula modem.

The lights of the device turn on.

If the device does not start, the battery may be empty. In this case, start by charging the battery with an AC charger (not included in the package).



The device will enter power-saving mode after 15 seconds if the device is not used. You can turn on the indicator lights by pressing the power button.

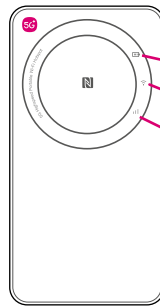

The Matkamokkula modem is ready for use:

- White battery indicator light (the battery is full)
- Blue or white WiFi indicator light
- Blue or white mobile network indicator light

For more information about the device's indicator lights, see the last page of this guide or visit dna.fi/tuki-mokkulat

3. Connecting devices wirelessly (WiFi)

You can find the necessary information under the back cover of the Matkamokkula modem and on the QR code sticker in the package.

1. Open the WiFi settings on the device you want to connect (e.g. your mobile phone or computer).
2. Select DNA-WIFI-XXXX from the list of WiFi networks.
3. Enter the password for the WiFi network.

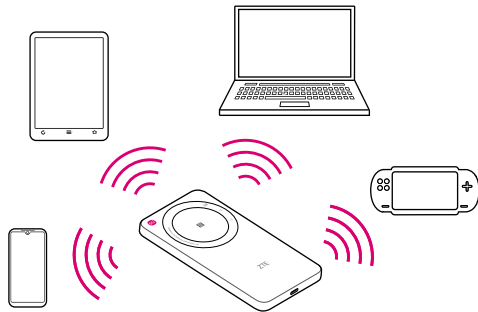

Connecting devices with a USB-C cable

For the highest quality internet connection, connect your device, such as a laptop, to the modem with a USB-C cable.

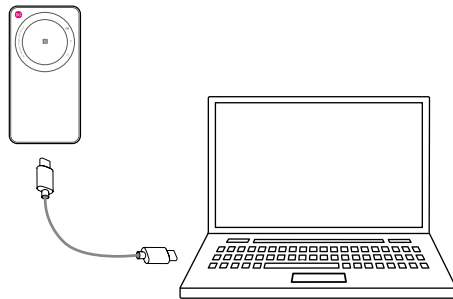

Changing the name and password of the WiFi network

If you want, you can change the name and password of your WiFi network to make the login process smoother. By setting up the login details yourself, it is easier to memorise them and to connect new devices.

1. Log in to the Matkamokkula modem configuration page at dna.wifi/

If the configuration page does not open, make sure your device is connected to your Matkamokkula modem network. You can find the Password for the configuration page under the back cover of the Matkamokkula modem.

<input type="password" value="Password"/>	<input type="button" value="Login"/>
---	--------------------------------------

2. The first time you log in, after accepting the manufacturer's privacy policy, you will be able to change the network name and password. Click Next. Once you have changed the WiFi network name and password, connect your devices to this network.





Network Name(SSID) *	<input type="text" value="DNA-WiFi-XXXX"/>	<input type="button" value="Next"/>
Password *	<input type="password" value="*****"/>	

You should also change the password for the Matkamokkula modem configuration page in the process (in the Login Password section of the System menu). This will further increase data security. Be sure to save the password for future reference.





Enter the current password for the configuration page in the Current Password field and a new password that is at least five characters long in the New Password and Confirm New Password fields and click Next.

Current Password *	<input type="password"/>	<input type="button" value="Next"/>
New Password *	<input type="password"/>	
Confirm New Password *	<input type="password"/>	

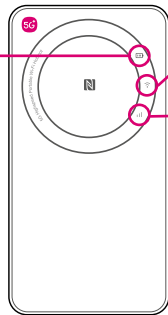
Indicator lights explained

Battery indicator light	
	Solid red light: The battery is low.
	Solid blue light: The battery is half full.
	Solid white light: The battery charge is high or the battery is full.
	Flashing light: The battery is charging.
You can check the battery level by logging in to the modem admin page. In constant use, the battery life is approximately 10 hours.	



WiFi indicator light	
	Solid white light: 5 GHz WiFi is active.
	Solid blue light: 2.4 GHz WiFi is active.
We recommend using the 5 GHz WiFi. If your device does not support 5 GHz WiFi, you can switch networks by pressing the WiFi network selection button.	
Mobile network indicator light	
	Solid white light: connected to the 5G network.
	Solid blue light: connected to the 4G network. The colour of the indicator light depends on your subscription type and the mobile network coverage in your area.
	Solid red light: <ul style="list-style-type: none">• The SIM card is not installed correctly.• Your device cannot connect to the mobile network, please contact the DNA Apuri support.

If the internet connection is not working, but the lights are on and the SIM card is correctly installed, try pressing the RESET button under the back cover of the modem for 10 seconds with a thin pin to reset it to factory settings.

Need help getting started? Let us help!

While setting up DNA Netti is easy, configuring a router and WiFi network may not be everyone's cup of tea. However, help is always near – we can even come to you if needed.

You can find our chat and more information at dna.fi/asennusapu or call **+358 (0)44 144 044** on weekdays 8:00–18:00.



This guide is made from
100% recycled paper.

